

Place Additional Pieces of Geogrid When Angle Exceeds 20 degs.

75mm of Soil Fill is Required Between Overlapping Geogrid for Proper Anchorage. (Typ.)

Additional Drainage Fill Extend Wall Height/2

Drainage Fill

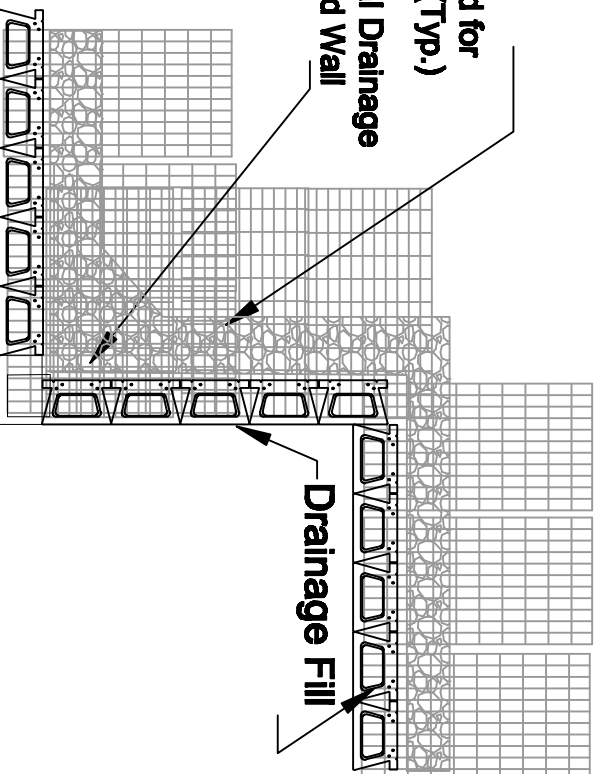

Geogrid Installation at Corners

No.	Date	Revision	By

The information on this drawing is for conceptual design and should not be used without the signature of a professional engineer. Details should be specific to the project and project site requirements.



www.basalite.com

Project		Basalite Standard Drawings	
Title		Installation at Corners	
Date	6/22/11	Drawn By:	SMR
Scale	As Noted	Sheet	